



# EFFICIENT FLOW AC CONTROLLER

ref : GEN001GRUECHY

## Dramatic Power Savings — Up to 75%

The Efficient Flow AC Controller is engineered to deliver exceptional energy efficiency by managing seawater flow to each air conditioning unit's condenser coil. This precise control is based on real-time compressor activity, allowing the system to provide only the necessary cooling, which leads to significant power savings—up to 75%.

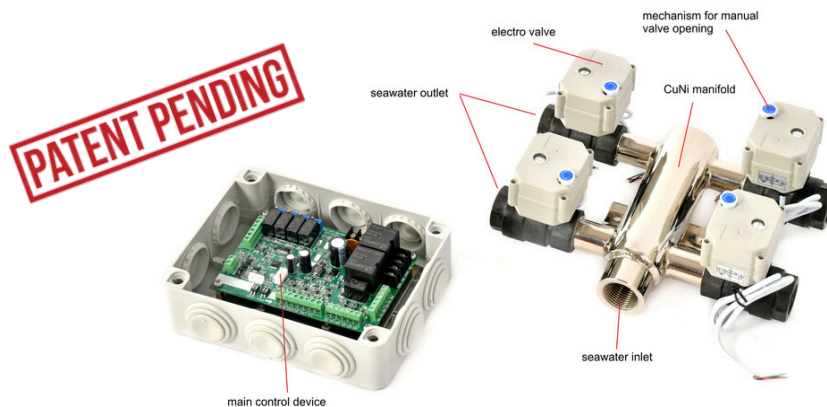

## Key Features & Benefits

- **Smart Flow Management :**

The dedicated PCB (Printed Circuit Board) ensures real-time control of electro valves and variable-speed pumps. It optimizes the water flow based on actual system demand, enhancing overall efficiency.

- **Dual Pump Operation :**

Dual Pump Operation: The system supports two pumps, which can alternate operations, balancing runtime for extended equipment lifespan.

- **Descaling Function :**

Built-in maintenance feature for easier system cleaning, reducing wear and tear on components and further extending the life of your system.

- **Enhanced Durability :**

A cupronickel manifold and high-quality electro valves ensure long-lasting performance even in demanding marine environments.

WE ARE A PROUD NOMINEE

in the category

COMFORT & ENTERTAINMENT AFLOAT

**DAME** DESIGN AWARDS 2024

Powered by  
**METS** MARINE EQUIPMENT TRADE SHOW

#DAMEDESIGNAWARDS2024

## Technical Specifications

- **Water Flow Components:**

Cupronickel manifold  
4 electro valves  
1 PCB control device  
Supports up to 2 variable-speed pumps and up to 4 electro valves

- **Power Supply Options:**

12VDC  
24VDC  
48VDC  
Suitable for a wide range of installation environments

- **Seawater Connections:**

Inlet: 1"  
Outlets: 3/4"

